

3/8" DRIVE SOCKETS & ATTACHMENTS

6 & 12 Point Standard Length

Hex Size	6 Point Part No.	12 Point Part No.	Overall Length in. a	Drive End in. b	Hex End in. c	Taper Length in. d	Bolt Clearance in. e
1/4"	TH8S	T8	0.94	0.66	0.41	0.44	0.17
5/16"	TH10	T10	0.94	0.66	0.46	0.44	0.32
3/8"	TH12	T12	0.94	0.66	0.56	0.44	0.38
7/16"	TH14	T14	0.94	0.66	0.66	—	0.44
1/2"	TH16	T16	0.97	0.72	0.72	—	0.51
9/16"	TH18	T18	0.97	0.78	0.78	—	0.57
5/8"	TH20	T20	1.01	0.86	0.86	—	0.64
11/16"	TH22	T22	1.01	0.95	0.95	—	0.70
3/4"	TH24	T24	1.13	1.00	1.00	—	0.76
13/16"	TH26	T26	1.13	1.08	1.08	—	0.83
7/8"	TH28	T28	1.25	1.17	1.17	—	0.88
15/16"	TH30	T30S	1.25	1.25	1.25	—	0.88
1"	TH32	T32S	1.25	1.25	1.30	—	0.90



Federal Spec. CDA 39-GP-12b U.S. GGG-W-641E ANSI B107.10M

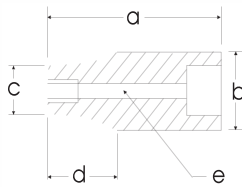

6 Point Deep Length

Hex Size	6 Point Part No.	Overall Length in. a	Drive End in. b	Hex End in. c	Taper Length in. d	Bolt Clearance in. e
1/4"	T80	2.48	0.67	0.41	0.54	0.18
5/16"	T100	2.48	0.67	0.47	0.54	0.18
3/8"	T120	2.48	0.67	0.56	0.87	0.31
7/16"	T140	2.48	0.67	0.67	-	0.37
1/2"	T160	2.48	0.71	0.71	-	0.47
9/16"	T180	2.48	0.79	0.79	-	0.51
5/8"	T200	2.48	0.87	0.87	-	0.62
11/16"	T220	2.48	0.94	0.94	-	0.66
3/4"	T240	2.48	1.02	1.02	-	0.74
13/16"	T260	2.48	1.10	1.10	-	0.88
7/8"	T280	2.48	1.18	1.18	-	0.88
15/16"	T300	2.48	1.26	1.26	-	0.88
1"	T320	2.48	1.34	1.34	-	0.88

Federal Spec. CDA 39-GP-12b U.S. GGG-W-641E ANSI B107.10M



12 Point Deep Length

Hex Size	12 Point Part No.	Overall Length in. a	Drive End in. b	Hex End in. c	Taper Length in. d	Bolt Clearance in. e
1/4"	LT8	2.56	0.75	0.43	0.51	0.18
5/16"	LT10	2.56	0.75	0.47	0.51	0.18
3/8"	LT12	2.56	0.75	0.57	0.51	0.31
7/16"	LT14	2.56	0.75	0.65	0.51	0.37
1/2"	LT16	2.56	0.75	0.75	-	0.47
9/16"	LT18	2.56	0.79	0.79	-	0.51
5/8"	LT20	2.56	0.87	0.87	-	0.62
11/16"	LT22	2.56	0.94	0.94	-	0.66
3/4"	LT24	2.56	1.02	1.02	-	0.74
13/16"	LT26	2.56	1.10	1.10	-	0.88
7/8"	LT28	2.56	1.18	1.18	-	0.88
15/16"	LT30	2.56	1.26	1.26	-	0.88
1"	LT32	2.56	1.34	1.34	-	0.88

Note: NOT FOR IMPACT USE. All items on this page are for hand use only.

Federal Spec. CDA 39-GP-12b U.S. GGG-W-641E ANSI B107.10M